



TUNAI BUTTON

BLUETOOTH REMOTE CONTROL

Instruction Manual



TUNAI BUTTON BLUETOOTH REMOTE



www.tunai-creative.com



www.facebook.com/tunai.global/



www.instagram.com/tunai_creative_eng/

WARRANTY

TUNAI provides a one-year product warranty for BUTTON, please keep your purchase proof and package.

The warranty does not cover the following:

1. Consumable parts (example: exterior coating damage).
2. Appearance damage.
3. Damage caused by improper use with other products.
4. Damage caused by failure to comply with instructions.
5. Purchase from unauthorized sellers.
6. Unauthorized disassembly of the product.
7. Damage caused by accident, abuse, improper use, fire, earthquake or other external causes.



IMPORTANT NOTE



1. TUNAI BUTTON is built with IPX5 graded material and is resistant to a sustained, low-pressure water jet spray. However, it is not 100% waterproof. Please do not put Button in the water as the warranty does not cover the water damages caused by improper use of the product.
2. DO NOT disassemble the product, unauthorized disassembly will result warranty to expire.

CUSTOMER SERVICE

Please contact the customer support if you have any questions or need any other assistance.



tunai@tunai-creative.com

TUNAI BUTTON OVERVIEW

FRONT SIDE

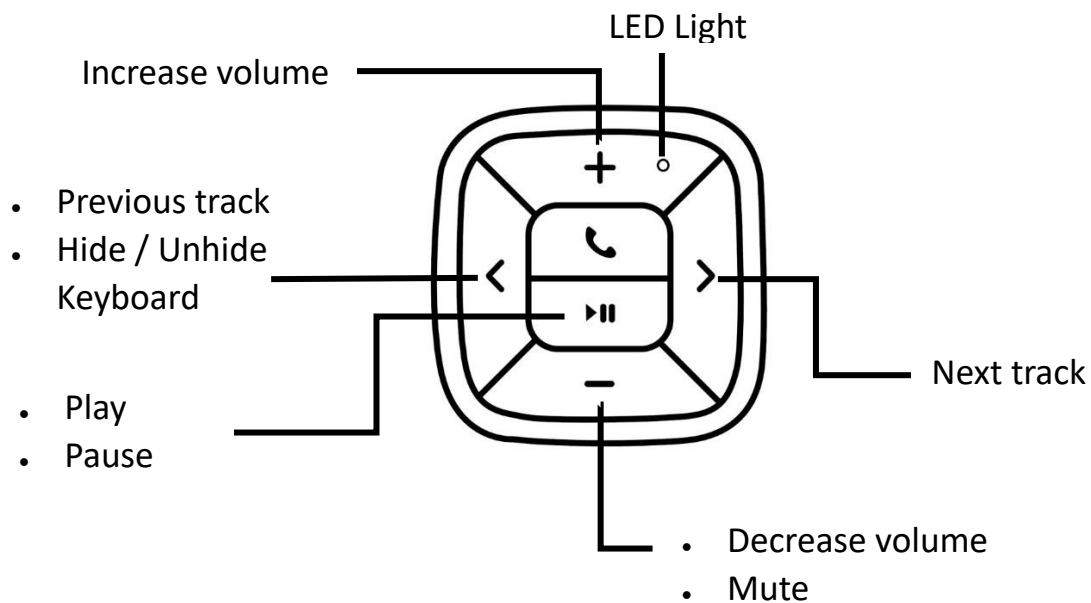

Note: This is a general overview of the TUNAI BUTTON. There is detailed information regarding different functions for iOS and Android further in this documentation.

BACK SIDE

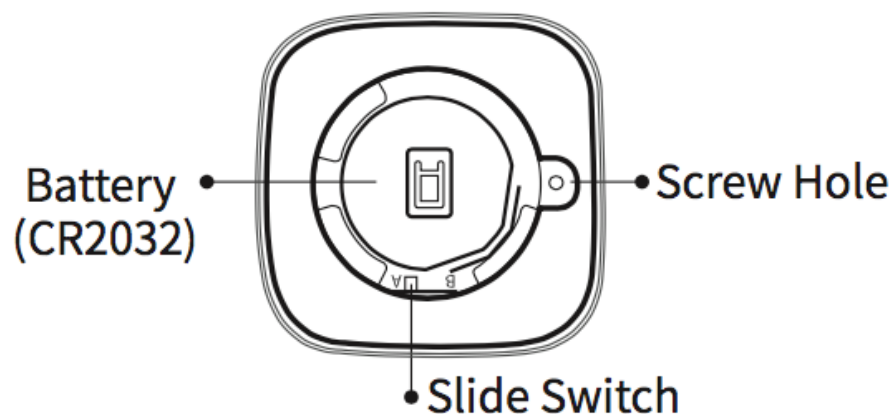

Note: Only iPhones with physical home button will need to switch the mode (see details in the iOS section). There is no difference in performance between mode A and B for Android users.

LED INDICATOR

LED Status

Slow Flash	Attempting to reconnect
Rapid Flash	Pairing Mode
Rapid Flash Once	Key pressed
Fast Rapid Flash	Incoming calls (iOS only)

Note: TUNAI BUTTON is only able to pair with one device at a time, and Button will only attempt to reconnect to the last device it was paired with.

INSTALL TUNAI BUTTON TO YOUR CAR

1. Select the proper size of rubber band included and mount the docking to one of the suggested locations on your steering wheel.

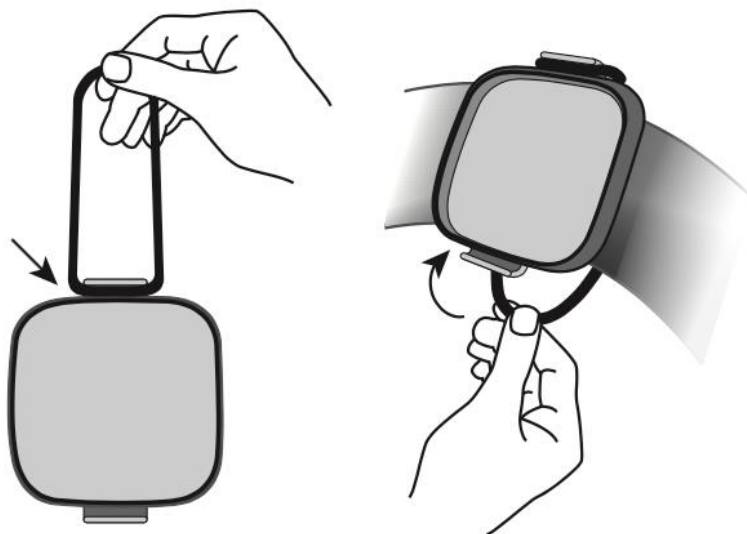
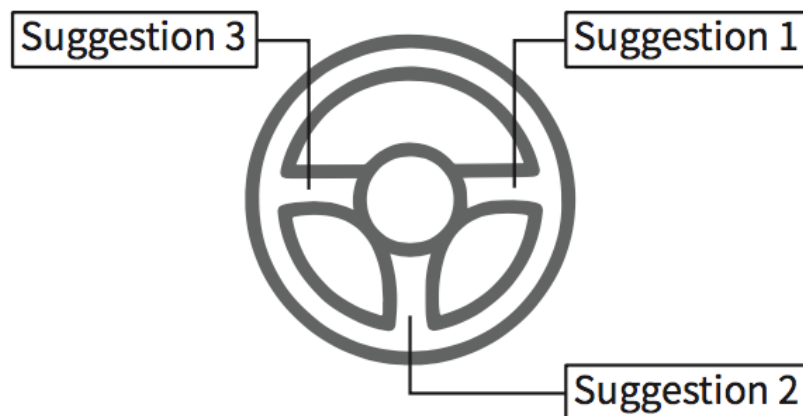

2. Place TUNAI BUTTON on the docking.

The magnet design helps TUNAI BUTTON to stay on the docking when driving but is also easy to remove from the docking and to use as camera shutter.

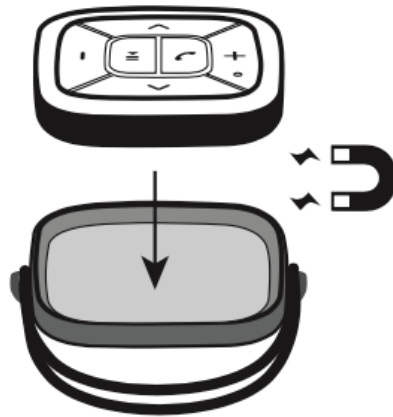

INSTALL TUNAI BUTTON TO YOUR BIKE

1. Select the proper size of rubber band included and mount the docking system to the suggested locations on your bike handle.

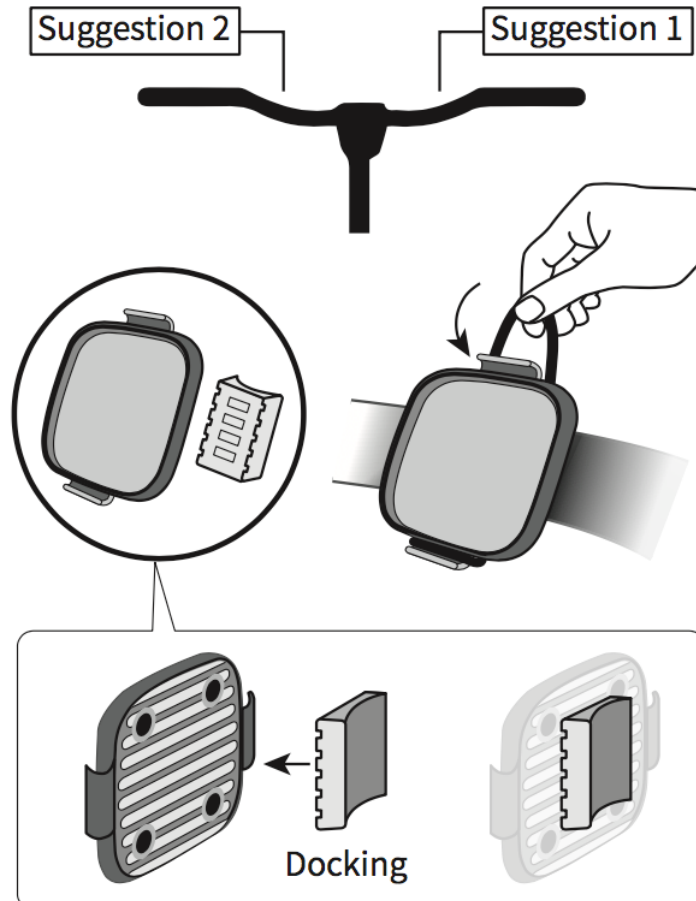

BATTERY

1. TUNAI BUTTON uses a standard CR2032 battery.
2. TUNAI BUTTON can operate up to 3 years with a standard CR2032 battery. This is based on 2 hours connection and 10 key press per day.

CHANGE BATTERY

1. Remove the screw on back of TUNAI BUTTON

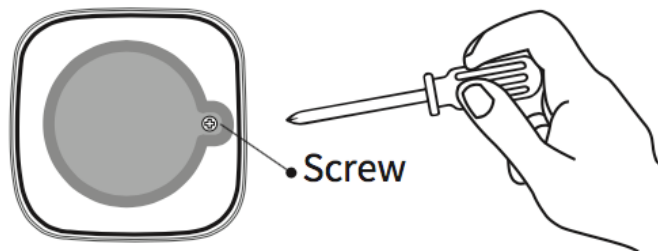

Note: TUNAI BUTTON does not ship with a screw.

2. Use the pin included to open the battery case.

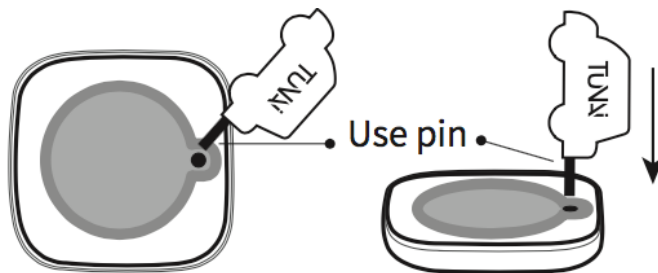

Note: Please use the pin included to open the back cover. Any scratches or damages on the back cover caused by improper usage of other tools to open the case will not be covered by the warranty.

3. Use only the standard CR2032 battery.

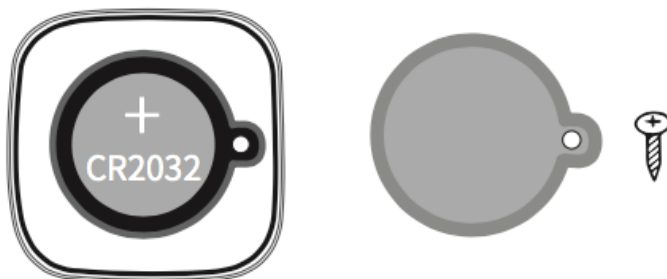

ENTER PAIRING MODE

1. TUNAI BUTTON will enter pairing mode when first activated.
2. To force TUNAI BUTTON to enter pairing mode, hold down “+” and “-” together for 3 seconds.
3. LED will flash rapidly when entering the pairing mode.

PAIRING

MODE A

1. TUNAI BUTTON enters pairing.
2. Search for “Tunai Button” on the Bluetooth menu of your device.
3. Click on “Tunai Button” to connect.

MODE B

1. TUNAI BUTTON enters pairing.
2. Search for “Tunai Button ADV” on the Bluetooth menu of your device.
3. Click on “Tunai Button ADV” to connect.

RECONNECT

Press any key and TUNAI BUTTON will search and reconnect with the paired device.

Note: TUNAI BUTTON is only able to pair with one device at a time, and Button will only attempt to reconnect to the last device it was paired with.

PAIRING WITH MULTIPLE DEVICES

1. TUNAI BUTTON can only pair with one device at a time.
2. If pairing with other devices is needed, re-entering PAIRING mode is required.
3. If TUNAI BUTTON is paired with multiple devices, you may see a previous paired “Tunai Button” on the paired list, but still see “Tunai Button” on new device search list. This is normal and is designed to avoid that the device being paired and locked by other devices.
 - ◆ If paired with Mode B, device name will show as “Tunai Button ADV”.

USING TUNAI BUTTON WITH iOS

iPhone 5, 5S, 6, 6S, 7, 7S, 8, 8S Users (With Physical Home Button)

In order to trigger Siri, iPhone owners with devices from iPhone 5 to iPhone 8 (with physical home button) will have to switch from Mode A to Mode B. Mode A is the default mode shipped.

iOS MODE SWITCH

1. **MODE A:** Disable triggering Siri from TUNAI BUTTON. (Default mode shipped)
2. **MODE B:** Enable triggering Siri from TUNAI BUTTON.
3. Use the switch on back of TUNAI BUTTON to choose between Mode A and Mode B.

Note: iPhone virtual keyboard will be hidden in Mode B. You will need to hold down “<” key to unhide the virtual keyboard.

STEPS FOR SWITCHING MODE

1. Remove the screw on back of TUNAI BUTTON

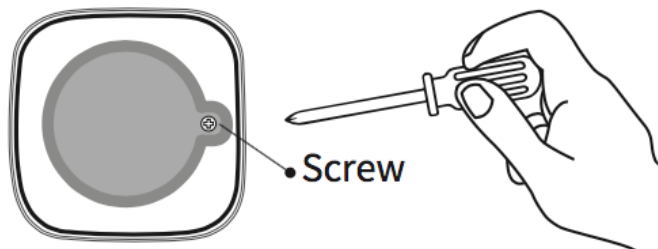

Note: TUNAI BUTTON does not ship with a screw.

2. Use the pin included to open the battery case.

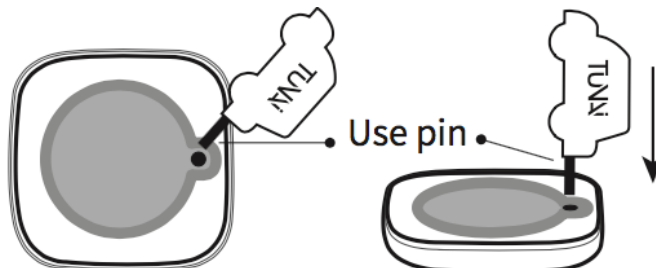

Note: Please use the pin included to open the back cover. Any scratches or damages on the back cover caused by improper usage of other tools to open the case will not be covered by the warranty.

3. Remove the battery °

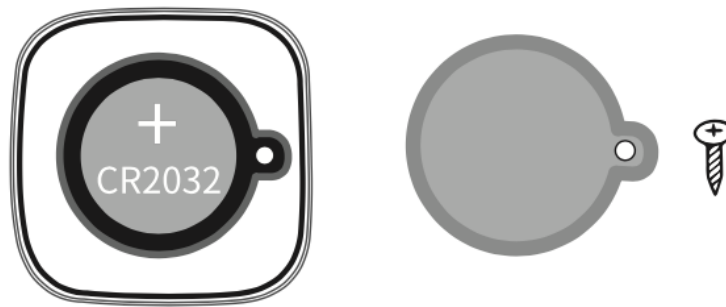

4. Switching the mode.

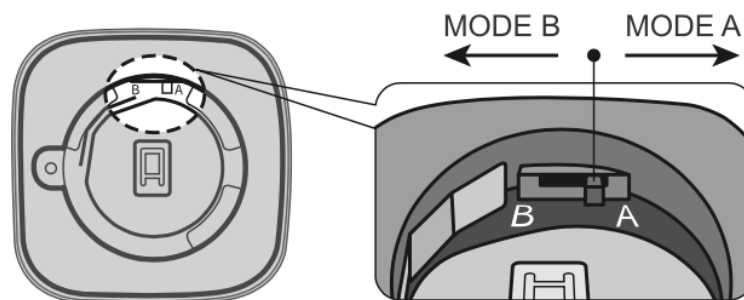







Key Description for iPhone 5,5S,6,6S,7,7S,8,8S Users

Key	Function	
+	Mode A	Short Press: Volume Up /Camera Shutter (When using camera)
	Mode B	
-	Mode A	Short Press: Volume Down/Camera Shutter (When using camera) Long Press: Mute
	Mode B	
>	Mode A	Short Press: Next Track
	Mode B	Long Press: Power Key / Reject call / End call
<	Mode A	Short Press: Previous Track
	Mode B	Short Press: Previous Track Long Press: Hide / Unhide Keyboard
▶	Mode A	Short Press: Play / Pause / Answer call
	Mode B	
☎	Mode A	Short Press: Play / Pause / Answer call
	Mode B	Short Press: Answer call / Home key shortcut Long Press: Trigger Siri

iPhone X, XR, XS, 11, 11 Pro etc. Users (Without the Physical Home Button)

The users with the iPhone without the physical home button will be able to trigger Siri in both Mode A and Mode B, therefore, there is no need to switch to Mode B to trigger Siri. (Mode A is the default shipped mode).

Key Description for iPhone X, XR, XS, 11, 11 Pro etc. Users

Key	Function	
	Mode A & B	Short Press: Volume Up /Camera Shutter (When using camera)
	Mode A & B	Short Press: Volume Down/Camera Shutter (When using camera) Long Press: Mute
	Mode A & B	Short Press: Next Track / Reject call Long Press: Trigger Siri / End Call
	Mode A	Short Press: Previous Track
	Mode B	Short Press: Previous Track Long Press: Hide / Unhide Keyboard
	Mode A & B	Short Press: Play / Pause / Answer call
	Mode A	Short Press: Play / Pause / Answer call
	Mode B	Short Press: Answer call / Home key shortcut







Voice Call App Support for iOS

APPs	Supported Features
Phone Call	Answer Call, Reject Call, End Call, Incoming Call Notification
Skype	Answer Call, Reject Call, End Call, Incoming Call Notification
LINE	Answer Call, End Call, Incoming Call Notification
WeChat	Answer Call, Incoming Call Notification

USING TUNAI BUTTON WITH ANDROID













There is no difference between using Mode A and Mode B for Android users. (Mode A is the default shipped mode).

Key Description for Android Users

Key	Function
	Short Press: Volume Up / Camera Shutter (When using camera) Long Press: Home Key Shortcut
	Short Press: Volume Down / Camera Shutter (When using camera) Long Press: Mute
	Short Press: Next Track Long Press: Power Key
	Short Press: Previous Track Long Press: Keyboard Hide / Unhide
	Short Press: Play / Pause
	Short Press: Home key Shortcut

Note:

- Compatibility:** Due to the nature of Android OS, some functions are not available for some devices. Below are some of the Android devices we have tested:

Model	Voice Call Support	
Samsung S6	Answer Call: 	Reject Call: 
Samsung S7 Edge	Answer Call: 	Reject Call: 
HTC U Ultra	Answer Call: 	Reject Call: 
HTC U11	Answer Call: 	Reject Call: 
Google Pixel 2 XL	Answer Call: 	Reject Call: 
ASUS Zenfone 5	Answer Call: 	Reject Call: 
Xiaomi Note Pro	Voice call key not supported	
HTC One 801e	Voice call key not supported	
ASUS Zenfone 2	Voice call key not supported	

List of incompatible Android Devices tested

Model	Capability
Xiaomi 5S Plus	Not compatible with TUNAI BUTTON
OPPO R9s	Not compatible with TUNAI BUTTON

2. Home Key: Home key shortcut varies from device to device. Please check your device manual to confirm the home shortcut key.

3. Limitation on answering the call: TUNAI BUTTON is unable to perform call function with most of the call within the communicating apps such as Facebook messenger, Line, or WhatsApp etc. TUNAI BUTTON also does not support the incoming call notification through rapidly flashing of the LED light.

4. Android setting: Some Android devices require assigning a specific key to a specific function (e.g. answering the call). For example, For Samsung Note 9, the original control for answering the call is to press the “+” key and to reject call is to press the “Power” key. If you wish to use TUNAI BUTTON to control Samsung Note 9, you will need to reassign the key differently.

◆ Some Android devices allow you to assign the key in the “Settings”. If you’re having trouble locating where to reset the key, you may also use 3rd party services such as “Button Mapper: Remap your keys” to reassign the keys.

HEAR THE DIFFERENCE



TUNAI CREATIVE INC.
3F., No.266, Sec. 1, Heping E. Rd.
Da;an Dist., Taipei City 10648 Taiwan
www.tunai-creative.com

